

EXTRA-WIDE CORNER TAPE

Update : 10/2023

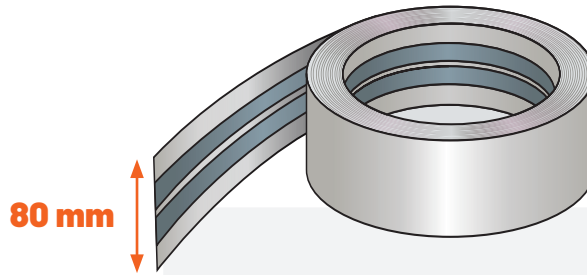

DESCRIPTION

The extra-wide corner tape can be used to reinforce plasterboard corners for BA18 or BA25 plasterboard in double skin installations (2x BA13).

ADVANTAGES

- Large 80mm width
- Good overlap of plasterboard edges
- Invisible after finishing
- High resistance

APPLICATION

Reinforcement of plasterboard corners.

INSTALLATION TIPS



1. Apply a coat of plasterboard joint filler adhesive over 50 to 60 mm on each side of the corner and position the reinforced strip.

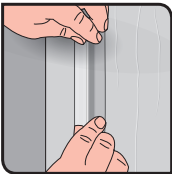

2. Fold the strip to form an angle and press the reinforced strip onto the plasterboard joint adhesive using the plastering knife (tighten the strip).



3. Cover the reinforced strip with two coats of plasterboard jointing adhesive (filler and finish).

WIDTH (mm) 80

MATERIAL Paper & steel

AVERAGE CONSUMPTION (/m²) 1,4

CONSOMMATION MOYENNE (/mL) 1

BREAKING LOAD (kg) 7

WET BREAKING LOAD (kg) 15

BULK DENSITY (kg/m²) 0,142

RESISTANCE TO SALINE MIST (h) 2600

REGULATIONS

NF EN 14353, EN 10152

ITEM

REFERENCE • GENCODE EAN

**LENGTH
(mm)**

**WEIGHT
(kg)**

EXTRA-WIDE CORNER TAPE 80mm x 30mL

A12062 • 3585501120626

30000

1,85

RELATED SEMIN PRODUCTS :

- SEMIN CE78 POWDER COATINGS, CE78 PASTE COATINGS

